

gabotherm[®]

Connections



gabopress H+S (Press Connections for PB Pipes)	74
Sanitary Connection Units	78
Radiator Connections	80
gabopress H+S (Press Connections for MV Pipes)	82
gaboflex (Clamp Connections)	92

gabopress Press Connections for PB Pipes:

Press fittings in numerous designs are available for gabotherm® polybutene pipes of dimensions 12 to 32 mm.

This includes T-pieces, couplings, reducers, elbows or end caps for the above-mentioned pipe dimensions.

All fittings can be pressed using a standard pressing tool and a pressing jaw with TH-contour.



The fittings of dimensions 15–32 mm are suitable for heating and sanitary installations. The dezincification-resistant fitting material as well as the seals both fulfil the requirements of the new German drinking water ordinance and the DVGW requirements according to W 534.



Sanitary Connection Units for Pressing or Clamping:

Mounting units for under-plaster or above-plaster mounting as well as for dry constructed walls were developed especially for sanitary installations.

The new valve support can be used both for above-plaster as well as for under-plaster mounting and can be combined with various connection elbows or boxes.

Radiator Connections for Pressing:

Press-T-pieces with an already soldered-on, nickel-plated copper pipe of different lengths (300, 500 and 1100 mm) for the different pipe dimensions are available for radiator connections from the floor or the wall.

A junction-free connection is possible using the press-junction-fitting (with insulation box) and the press coupling connection in different lengths.

Wall connections with ½" internal thread can be realised using the connection box for PB pipe 18 x 2.0 mm.

Attention:

When using PE-Xc and PE-RT pipes, at least two bends of 90° with a centre-to-centre distance of 250 mm must be installed before each distributor connection and each radiator connection in both the inlet and the return flow.

For the remaining pipe sections, the longitudinal expansion must be taken into account.

gabopress Pressing Connections for MV pipes:

Press fittings in various designs are available for gabotherm® metal compound pipes (MV pipes) of dimensions 14 to 63 mm.

All fittings are suitable for heating and sanitary installations. The dezincification-resistant fitting material as well as the seals both fulfil the requirements of the new German drinking water ordinance and the DVGW requirements according to W 534.

All fittings can be pressed using a standard pressing tool and a pressing jaw with TH-contour.

gaboflex Clamping Connections:

Screw fittings for:

- ⇒ PB pipe dimensions 14–20 mm (12 x 1.3 mm for heating only)
- ⇒ PE-Xc pipe dimensions 16 x 2.2 mm and 20 x 2.8 mm
- ⇒ PE-RT pipe dimensions 14 x 2.0 mm

Coupling adapters with ¾" euro-cone (e.g. for distributor connections), couplings with a transition to metal thread (½" external thread) and main bodies such as elbows and T-pieces with ¾" euro-cone for accommodating coupling adapters of different dimensions are available.

Fittings and Other System Parts

Press Coupling

for gabotherm® PB pipes

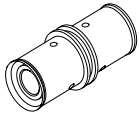

Code	Type	Unit	Item ID
GT-PK	12 x 1.3*	10 pieces	12735
	15/15	10 pieces	12711
	16/16	10 pieces	06284
	18/18	10 pieces	06285
	20/20	10 pieces	06287
	25/25	10 pieces	05425
	32/32	10 pieces	05308

* for heating installations only

Press Coupling Reduced

for gabotherm® PB pipe

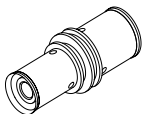

Code	Type	Unit	Item ID
GT-PKR	18/15	10 pieces	00423
	18/16	10 pieces	06270
	20/15	10 pieces	00416
	20/16	10 pieces	06267
	20/18	10 pieces	06268
	25/16	10 pieces	12634
	25/18	10 pieces	09085
	25/20	10 pieces	11626
	32/25	10 pieces	09084

Press Elbow 45°

for 45° bends in gabotherm® PB pipes

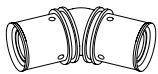

Code	Type	Unit	Item ID
GT-PW 45°	25	5 pieces	05963
	32	5 pieces	05985

Press Elbow 90°

for 90° bends in gabotherm® PB pipes

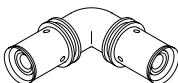

Code	Type	Unit	Item ID
GT-PW 90°	15	10 pieces	00430
	16	10 pieces	11067
	18	10 pieces	07762
	20	10 pieces	10408
	25	5 pieces	05992
	32	5 pieces	06022

Press-T-Piece
for gabotherm® PB pipes

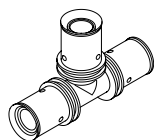

Code	Type	Unit	Item ID
GT-PT	15/15/15	10 pieces	00431
	16/16/16	10 pieces	06289
GT-M-PT	17/17/17	10 pieces	00661
GT-PT	18/18/18	10 pieces	06290
	20/20/20	10 pieces	06291
	25/25/25	5 pieces	05783
	32/32/32	5 pieces	05788

Press-T-Piece Reduced
for gabotherm® PB pipes

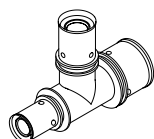

Code	Type	Unit	Item ID
GT-PTR	18/15/18	10 pieces	00415
	18/16/18	10 pieces	06293
	18/15/15	10 pieces	00424
	18/16/16	10 pieces	06292
	20/18/20	10 pieces	05775
	20/18/18	10 pieces	06294
	20/15/20	10 pieces	00413
	20/16/20	10 pieces	06295
	20/15/15	10 pieces	00414
	20/16/16	10 pieces	06296
	25/25/18	5 pieces	05873
	25/18/25	5 pieces	05872
	25/18/18	5 pieces	05869
	18/25/18	5 pieces	05835
	25/20/25	5 pieces	10494
	25/20/20	5 pieces	10495
	32/32/18	5 pieces	05954
	32/18/32	5 pieces	05890
	32/20/25	5 pieces	12202
	32/20/32	5 pieces	12203
32/25/32	5 pieces	05953	
32/25/25	5 pieces	05952	
32/25/18	5 pieces	05900	
25/32/25	5 pieces	05879	

Press-T-Piece

with internal thread for gabotherm® PB pipes



Code	Type	Unit	Item ID
GT-PTG	25/ ¾" / 25	5 pieces	05795
	32/ 1" / 32	5 pieces	05804

Press Coupling Adapter

made from brass, with ¼" flanged nut and euro-cone for gabotherm® PB pipes

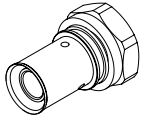

Code	Type	Unit	Item ID
GT-PKA	12 x 1.3 not nickel-plated	10 pieces	12734*
	15 nickel-plated	10 pieces	12704
	16 nickel-plated	10 pieces	11988
	18 nickel-plated	10 pieces	01144

* for heating installations only

Press Coupling with Cap Nut

made from brass, flat-sealing, for fittings connections of gabotherm® PB pipes

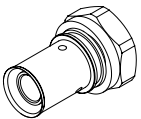

Code	Type	Unit	Item ID
GT-PKU	18 ¾"	10 pieces	11991
	18 ¾"	10 pieces	11990
	20 ¾"	10 pieces	12643
	20 ¾" nickel-plated	10 pieces	12642
	25 1"	10 pieces	05375
	32 1¼"	10 pieces	05365

Press Transition Coupling, with External Thread

from gabotherm® PB pipe to metal thread.

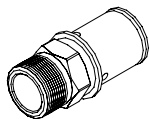

Code	Type	Unit	Item ID
GT-PUK	12 ½" external thread	10 pieces	00312*
	15 ½" external thread	10 pieces	00425
	16 ½" external thread	10 pieces	06271
	18 ½" external thread	10 pieces	06272
	18 ¾" external thread	10 pieces	05782
	20 ¾" external thread	10 pieces	06273
	25 ¾" external thread	10 pieces	05354
	32 1" external thread	10 pieces	05343

* for heating installations only

Press Transition Coupling, with Internal Thread
from gabotherm® PB pipe to metal thread

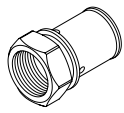

Code	Type	Unit	Item ID
GT-PUKI	15 1/2" internal thread	10 pieces	00412
	16 1/2" internal thread	10 pieces	12635
	18 1/2" internal thread	10 pieces	02357
	20 1/2" internal thread	10 pieces	12636
	20 3/4" internal thread	10 pieces	12637

Press End Cap
for sealing the universal pipe PB. *For heating installations only*

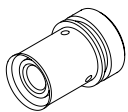

Code	Type	Unit	Item ID
GT-PEK	15	10 pieces	00407
	16	10 pieces	11627
	18	10 pieces	11628
	20	10 pieces	11629

Spare Press Sleeve
made from stainless steel for press fittings, d12-d32

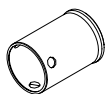

Code	Type	Unit	Item ID
GT-PH	12	20 pieces	12760
	15	20 pieces	12006
	16	20 pieces	11068
	18	20 pieces	06277
	20	20 pieces	06278
	25	20 pieces	03950
	32	20 pieces	03958

Connection Units for Sanitary Installations for Pressing

Mounting Unit for PB Pipes 18 x 2.0

consisting of: valve support (GT-ATE or GT-AE) with centre-to-centre distance 80 or 150 mm incl. fastening screws, 1 or 2 pieces press wall elbows 18-½" internal thread (GT-PWW)

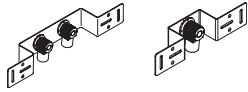

Code	Type	Unit	Item ID
GT-AE1 P-AT	1 connection	1 piece	09093
GT-AE2 P-AT	2 connections	1 piece	07964

Mounting Unit for PB Pipes 18 x 2.0

consisting of: connecting strip with variable centre-to-centre distance 80–200 mm, 2 pieces plastic boxes with press wall elbows

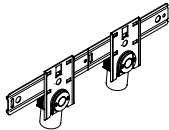

Code	Type	Unit	Item ID
GFL-PAE2-V		1 piece	07962

Press Fittings and Accessories for Sanitary Installations with gabotherm® PB Pipes 15 x 1.5, 16 x 2.0, 18 x 2.0 mm

Valve Support

for fastening the press wall elbows (GT-PWW 15/16/18) at a centre-to-centre distance of 80 or 150 mm, for under-plaster or above-plaster mounting.

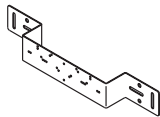

Code	Type	Unit	Item ID
GT-AT E (single)	1 connection	1 piece	00496
GT-AT	2 connections	1 piece	00405

Press Wall Elbow

Ø15, Ø16, Ø18, reduced, ½" internal thread.

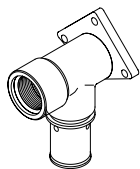

Code	Type	Unit	Item ID
GT-PWW	15 / ½" internal thread	10 pieces	00410
	16 / ½" internal thread	10 pieces	12204
	18 / ½" internal thread	10 pieces	07764

Insulation Box with Rubber Pad

for press wall elbows (GT-PWW 15/16/18) in connection with valve support (GT-AT) for impact sound insulation.

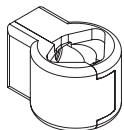

Code	Type	Unit	Item ID
GT-DBW		1 piece	00473

Press Connection Elbow

Ø15, Ø16, Ø18, reduced, 1/2" external thread.

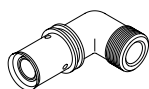

Code	Type	Unit	Item ID
GT-PAWR	15 / 1/2" external thread	10 pieces	00409
	16 / 1/2" external thread	10 pieces	12216
	18 / 1/2" external thread	10 pieces	07763

Double Press Wall Elbow

made from brass, wall elbow with double connection Ø18, with 1/2" internal thread.

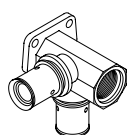

Code	Type	Unit	Item ID
GT-PWWD	18 / 1/2" internal thread	10 pieces	12205

Sanitary Fittings for Front-Wall Installation (Dry Construction) with gabotherm® PB Pipes 18 x 2.0 mm

Press Double Elbow

1/2" internal thread, 3/4" external thread, thread length 35 and 55 mm.

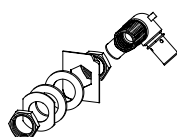

Code	Type	Unit	Item ID
GFL-PDW	35/ 1/2" internal thread, 3/4" external thread	10 pieces	07952
	55/ 1/2" internal thread, 3/4" external thread	10 pieces	07951

Press Connection Elbow

1/2" internal thread, 3/4" external thread, thread length 35 and 55 mm.

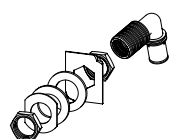

Code	Type	Unit	Item ID
GFL-PAW	35/ 1/2" internal thread, 3/4" external thread	10 pieces	07954
	55/ 1/2" internal thread, 3/4" external thread	10 pieces	07953

Press Connection Nipple

1/2" internal thread, 3/4" external thread, for fittings connections, press connection as transition to pipe, thread length 35 and 55 mm.

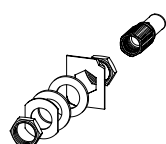

Code	Type	Unit	Item ID
GFL-PAN	35/ 1/2" internal thread, 3/4" external thread	10 pieces	08084
	55 / 1/2" internal thread, 3/4" external thread	10 pieces	08083

Radiator Connection Accessories

Radiator Connection with Press Coupling for gabotherm® PB Pipes

for wall and floor connections, with soldered-on semi-rigid Cu-pipe d 15, nickel-plated, l = 300, 500 or 1100 mm, suited especially in connection with press junction fitting.

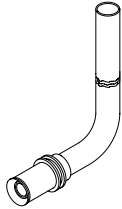

Code	Type	Unit	Item ID
GT-PLCU	15/300	2 pieces	00247
	15/500	2 pieces	00248
	15/1100	2 pieces	00417
	16/300	2 pieces	06338
	16/500	2 pieces	00234
	16/1100	2 pieces	08117
	18/300	2 pieces	07498
	18/500	2 pieces	00420
	18/1100	2 pieces	08116
	20/300	2 pieces	07495
	20/500	2 pieces	00419
	20/1100	2 pieces	08115

Radiator Connection with Press-T-Piece

for wall and floor connections, with soldered-on semi-rigid Cu-pipe d 15, nickel-plated, l = 300, 500 or 1100 mm.

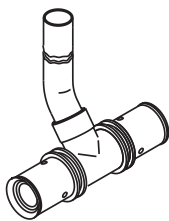

Code	Type	Unit	Item ID
GT-PTCU	15/500	2 pieces	00250
	15/1100	2 pieces	00418
	16/300	2 pieces	06339
	16/500	2 pieces	06340
	16/1100	2 pieces	08120
	18/300	2 pieces	06344
	18/500	2 pieces	00422
	18/1100	2 pieces	08119
	20/300	2 pieces	06345
	20/500	2 pieces	00421
	20/1100	2 pieces	08118

Connection Unit

for radiator connections from the wall in connection with connecting flange (Item ID 06110)
for pipe connection 18 x 2 for pressing, consisting of plastic wall box and brass wall elbow ½" internal thread.

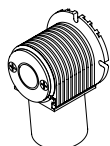

Code	Type	Unit	Item ID
GFL-AE2 P	1 connection	1 piece	09076

Press Junction Fitting

with press connections, incl. insulation box made from polystyrene.

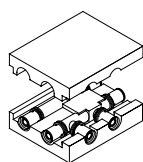

Code	Type	Unit	Item ID
GT-PKF	18/18/18	1 piece	08134
	20/15/20	1 piece	08135
	20/16/20	1 piece	08136 *
Spare insulation box		1 piece	06735

* per order

Fittings and Other System Parts

Press Coupling

for gabotherm® MV pipes

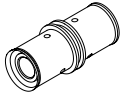

Code	Type	Unit	Item ID
GT-M-PK	14/14	10 pieces	00579
	16/16	10 pieces	00532
	18/18	10 pieces	00551
	20/20	10 pieces	00533
	26/26	5 pieces	00331
	32/32	5 pieces	00332
	40/40	5 pieces	00552
	50/50	5 pieces	00553
	63/63 *		on request

* item only available per order with delivery period

Press Coupling Reduced

for gabotherm® MV pipes

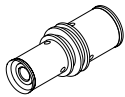

Code	Type	Unit	Item ID
GT-M-PKR	16/14	10 pieces	00557
	18/14	10 pieces	00558
	18/16	10 pieces	00559
	20/16	10 pieces	00560
	20/18	10 pieces	00561
	26/15**	5 pieces	00333
	26/16	5 pieces	00563
	26/18	5 pieces	00334
	26/20	5 pieces	00343
	32/16	5 pieces	00565
	32/18	5 pieces	00335
	32/20	5 pieces	00566
	32/26	5 pieces	00336
	40/26	5 pieces	00568
	40/32	5 pieces	00569
	50/26	5 pieces	00570

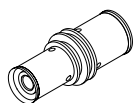

50/32	5 pieces	00571
50/40	5 pieces	00572
63/26 *		on request
63/32 *		on request
63/40 *		on request
63/50 *		on request

* item only available per order with delivery period

** Kombi-Fitting; for multilayer compound pipe and polybutene pipe

Press Elbow 45°

for 45° bends in gabo therm® MV pipes

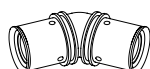

Code	Type	Unit	Item ID
GT-M-PW 45°	26 x 3	5 pieces	00461
	32 x 3	5 pieces	00463
	40 x 3.5	5 pieces	00573
	50 x 4	5 pieces	00578
	63 x 4.5 *		on request

* item only available per order with delivery period

Press Elbow 90°

for 90° bends in gabo therm® MV pipes



Code	Type	Unit	Item ID
GT-M-PW 90°	14 x 2	10 pieces	00653
	16 x 2	10 pieces	00538
	17 x 2	10 pieces	00654
	18 x 2	10 pieces	00655
	20 x 2	10 pieces	00656
	26 x 3	5 pieces	00322
	32 x 3	5 pieces	00323
	40 x 3.5	5 pieces	00657
	50 x 4	2 pieces	00658
	63 x 4.5 *		on request

* item only available per order with delivery period

Press-T-Piece

for gabotherm® MV pipes

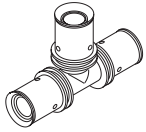

Code	Type	Unit	Item ID
GT-M-PT	14/14/14	10 pieces	00659
	16/16/16	10 pieces	00535
	18/18/18	10 pieces	00662
	20/20/20	10 pieces	00663
	26/26/26	5 pieces	00324
	32/32/32	5 pieces	00455
	40/40/40	5 pieces	00664
	50/50/50	5 pieces	00665
	63/63/63 *		on request

* item only available per order with delivery period

Press-T-Piece, Reduced

for gabotherm® MV pipes, centrepiece reduced

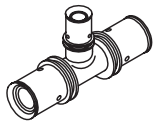

Code	Type	Unit	Item ID
GT-M-PTR	16/14/16	10 pieces	00669
	18/14/18	10 pieces	00670
	18/16/18	10 pieces	00671
	20/14/20	10 pieces	00672
	20/16/20	10 pieces	00673
	20/18/20	10 pieces	00675
	26/15/26 **	5 pieces	00325
	26/16/26	5 pieces	00676
	26/18/26	5 pieces	00326
	26/20/26	5 pieces	00677
	32/15/32 **	5 pieces	00327
	32/16/32	5 pieces	00678
	32/18/32	5 pieces	00328
	32/20/32	5 pieces	00537
	32/26/32	5 pieces	00329

** Kombi-Fitting: for multilayer compound pipe and polybutene pipe

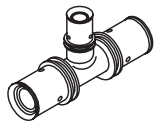

40/26/40	5 pieces	00681
40/32/40	5 pieces	00682
50/26/50	5 pieces	00683
50/32/50	5 pieces	00684
50/40/50	5 pieces	00685
63/32/63 *		on request
63/40/63 *		on request
63/50/63 *		on request

* item only available per order with delivery period

** Kombi-Fitting: for multilayer compound pipe and polybutene pipe

Press-T-Piece, Reduced
for gabootherm® MV pipes.



Code	Type	Unit	Item ID
GT-M-PTR	16/14/14	10 pieces	00686
	18/16/14	10 pieces	00687
	18/16/16	10 pieces	00688
	20/14/16	10 pieces	00689
	20/16/16	10 pieces	00690
	20/18/18	10 pieces	00691
	20/16/18	10 pieces	00692
	20/20/16	10 pieces	00693
	26/16/20	5 pieces	00694
	26/18/18	5 pieces	00330
	26/18/20	5 pieces	00695
	26/20/16	5 pieces	00696
	26/20/20	5 pieces	00697
	26/26/16	5 pieces	00700
	26/26/20	5 pieces	00701
	32/20/26	5 pieces	00702
	32/26/26	5 pieces	00703
	32/32/20	5 pieces	00704
	32/32/26	5 pieces	00705



40/32/32	5 pieces	00706
40/26/32	5 pieces	00707
40/40/26	5 pieces	00708
40/40/32	5 pieces	00710
50/40/40	5 pieces	00711
50/32/40	5 pieces	00712
50/50/32	5 pieces	00713
50/50/40	5 pieces	00714
63/40/50 *		on request
63/50/50 *		on request
63/63/40 *		on request
63/63/50 *		on request

* item only available per order with delivery period

Press-T-Piece, Extended
for gabotherm® MV pipes.

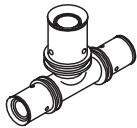

Code	Type	Unit	Item ID
GT-M-PTE	14/16/14	10 pieces	00715
	16/18/16	10 pieces	00716
	16/20/16	10 pieces	00717
	20/26/20	5 pieces	00718
	26/32/26	5 pieces	00719
	32/40/32	5 pieces	00720

Press-T-Piece
with internal thread for gabotherm® MV pipes

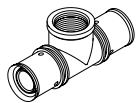

Code	Type	Unit	Item ID
GT-M-PTG	26/ 3/4" /26	5 pieces	00468
	32/ 3/4" /32	5 pieces	00469
	32/ 1" / 32	5 pieces	00466
	32/ 1 1/4" /32	5 pieces	00721
	40/ 1" /40	5 pieces	00722
	40/ 1 1/4" / 40	5 pieces	00723
	50/ 1 1/4" / 50	5 pieces	00724
	50/ 1 1/2 "50	5 pieces	00726

63 / 1 1/2" / 63 *	on request
63 / 2" / 63 *	on request

* item only available per order with delivery period

Press Coupling with Cap Nut

flat-sealing, for connecting gabotherm® MV pipes to fittings



Code	Type	Unit	Item ID
GT-M-PKU	16 x 3/4"	10 pieces	00803
	20 x 3/4"	10 pieces	00549
	26 x 1"	5 pieces	00470
	32 x 1 1/4"	5 pieces	00471
	40 x 1 1/2"	5 pieces	00550

Press Transition Coupling, with External Thread

from gabotherm® MV pipes to metal thread;

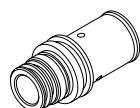

Code	Type	Unit	Item ID
GT-M-PUK	14 x 1/2" external thread	10 pieces	00806
	16 x 1/2" external thread	10 pieces	00531
	18 x 1/2" external thread	10 pieces	00727
	20 x 3/4" external thread	10 pieces	00728
	26 x 3/4" external thread	5 pieces	00337
	32 x 1" external thread	5 pieces	00338
	40 x 1 1/4" external thread	5 pieces	00729
	50 x 1 1/2" external thread	5 pieces	00730
	63 x 2" external thread *	on request	

* item only available per order with delivery period

Press Transition Coupling, with Internal Thread

from gabotherm® MV-pipe to metal thread;

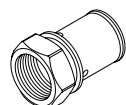

Code	Type	Unit	Item ID
GT-M-PUKI	26 3/4" internal thread	5 pieces	00464
	32 1" internal thread	5 pieces	00465

Spare Press Sleeve

made from stainless steel for MV press fittings;

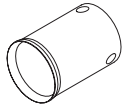

Code	Type	Unit	Item ID
GT-M-PH	14	10 pieces	00731
	15	5 pieces	00426
	16	10 pieces	00732
	18	10 pieces	00427
	20	10 pieces	00734
	26	5 pieces	00428
	32	5 pieces	00429
	40	5 pieces	00735
	50	5 pieces	00736
	63 *		on request

* item only available per order with delivery period

O-Rings



Code	Type	Unit	Item ID
GT-M-OR	14	100 pieces	00737
	16	100 pieces	00738
	18	100 pieces	00740
	20	100 pieces	00741
	26	100 pieces	00742
	32	100 pieces	00743
	40	50 pieces	00744
	50	50 pieces	00745
	63 *		on request

* item only available per order with delivery period

Press Screw Connection

with euro-cone 3/4", nickel-plated

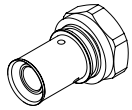

Code	Type	Unit	Item ID
GT-M-PKA	14	10 pieces	00805
	16	10 pieces	00746
	18	10 pieces	00747
	20	10 pieces	00748

Press Wall Elbow Short

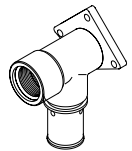

Code	Type	Unit	Item ID
GT-M-PWW	14 1/2" internal thread	10 pieces	00679
	16 1/2" internal thread	10 pieces	00530
	18 1/2" internal thread	10 pieces	00749
	20 1/2" internal thread	10 pieces	00750
	20 3/4" internal thread	10 pieces	00751

Sound Insulation Element

for wall elbow short

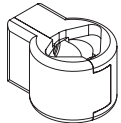

Code	Type	Unit	Item ID
GT-M-SEW	1/2"	10 pieces	00752
	3/4"	10 pieces	00753

Double Press Wall Elbow Short



Code	Type	Unit	Item ID
GT-M-PWWD	16 1/2" internal thread	10 pieces	00756
	18 1/2" internal thread	10 pieces	00755

Sound Insulation Element

for double wall elbow

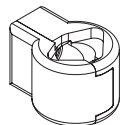

Code	Type	Unit	Item ID
GT-M-SEWD		10 pieces	00760

Press Wall Elbow Long

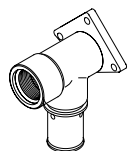

Code	Type	Unit	Item ID
GT-M-PWWL	14 1/2" internal thread	10 pieces	00757
	16 1/2" internal thread	10 pieces	00758
	18 1/2" internal thread	10 pieces	00759

Sound Insulation Element

for wall elbow long

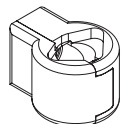

Code	Type	Unit	Item ID
GT-M-SEWL		10 pieces	00761

Transition Elbow with External Thread

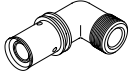

Code	Type	Unit	Item ID
GT-M-PAWR	14 ½" external thread	10 pieces	00762
	16 ½" external thread	10 pieces	00763
	18 ½" external thread	10 pieces	00764
	20 ¾" external thread	10 pieces	00765

Junction-Free T-Piece Unmounted

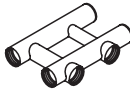

Code	Type	Unit	Item ID
GT-M-KF	½"	1 piece	00766

Threaded Part

for junction-free T-piece ½"

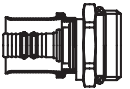

Code	Type	Unit	Item ID
GT-M-ET	14 ½"	10 pieces	00767
	16 ½"	10 pieces	00768
	18 ½"	10 pieces	00769
	20 ½"	10 pieces	00770

Insulation Box

for junction-free T-piece ½"



Code	Type	Unit	Item ID
GT-M-DBKF	½"	1 piece	00771

Radiator Connection T-Piece

with soldered-on semi-rigid Cu-pipe d 15, nickel-plated, l = 300 or 1100 mm

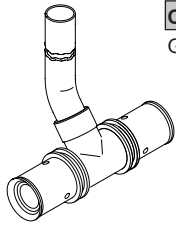

Code	Type	Unit	Item ID
GT-M PTCU	14 / 300 mm	2 pieces	00772
	16 / 300 mm	2 pieces	00773
	17 / 300 mm	2 pieces	00774
	18 / 300 mm	2 pieces	00775
	20 / 300 mm	2 pieces	00776
	14 / 1100 mm	2 pieces	00778
	16 / 1100 mm	2 pieces	00779
	17 / 1100 mm	2 pieces	00780
	18 / 1100 mm	2 pieces	00781
	20 / 1100 mm	2 pieces	00782

Radiator Connection Elbow

with soldered-on semi-rigid Cu-pipe d 15, nickel-plated, l = 300 or 1100 mm

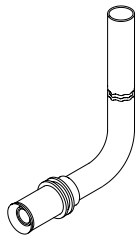

Code	Type	Unit	Item ID
GT-M-PLCU	14 / 300 mm	2 pieces	00783
	16 / 300 mm	2 pieces	00784
	17 / 300 mm	2 pieces	00785
	18 / 300 mm	2 pieces	00786
	20 / 300 mm	2 pieces	00787
	14 / 1100 mm	2 pieces	00788
	16 / 1100 mm	2 pieces	00789
	17 / 1100 mm	2 pieces	00790
	18 / 1100 mm	2 pieces	00791
	20 / 1100 mm	2 pieces	00792

Connection Units (Clamping) for Sanitary Installations

Connection Unit Double

for PB Pipes 14 x 2,0 – 20 x 2,0 or PE-Xc Pipes 16 x 2,2 and 20 x 2,8

suitable for all connections with fittings and devices with ½" thread connection, connection using euro-cone and coupling adapter GT-KA (to be ordered separately); fastening spacing 80 or 150 mm; suitable for above and under-plaster mounting, consisting of: valve support, 2 pieces plaster boxes with wall elbows and screws

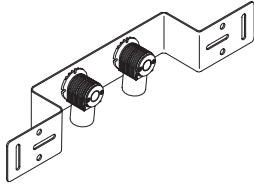

Code	Unit	Item ID
GT-AE 2-AT	1 unit	09072

Connection Unit Single

for PB Pipes 14 x 2,0 – 20 x 2,0 or PE-Xc Pipes 16 x 2,2 and 20 x 2,8

suitable for all connections of fittings and devices with ½" thread connection, connection using euro-cone and coupling adapter GT-KA (to be ordered separately); fastening spacing 80 or 150 mm; suitable for above and under-plaster mounting, consisting of: valve support single, 1 piece plaster box with wall elbow and screws

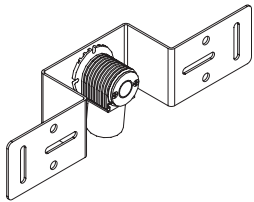

Code	Unit	Item ID
GT-AE 1-AT	1 unit	09073

Please order coupling adapter separately.

Variable Mounting Unit

for PB Pipes 14 x 2,0 – 20 x 2,0 or PE-Xc Pipes 16 x 2,2 and 20 x 2,8

consisting of: connecting strip with variable centre-to-centre distance 80–200 mm, 2 pieces plaster boxes with wall elbows and screws

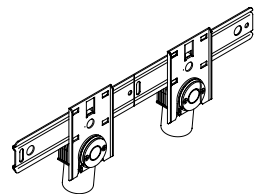

Code	Unit	Item ID
GFL-AE2-V	1 piece	09340

Please order coupling adapter separately.

Attention: discontinued item, available only as long as stock lasts.

Mounting Unit with Double Box

for PB Pipes 14 x 2,0 – 20 x 2,0 or PE-Xc Pipes 16 x 2,2 and 20 x 2,8

consisting of: connecting strip with variable centre-to-centre distance 80–200 mm, pieces plaster boxes with double wall elbows

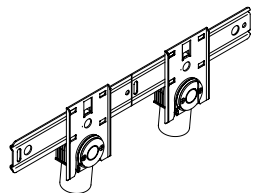

Code	Unit	Item ID
GFL-DD	1 piece	05724

Please order coupling adapter separately.

Attention: discontinued item, available only as long as stock lasts.

Fittings and Accessories for Sanitary Installations:

Valve Support

for fastening the press wall elbows (GT-PWW 15/16/18) with a centre-to-centre distance of 80 or 150 mm, for above and under-plaster mounting. Incl. suitable fastening screws, dowels and self-tapping screws for fastening the boxes and elbows.

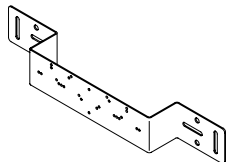

Code	Type	Unit	Item ID
GT-AT E	1 connection	1 piece	00496
GT-AT	2 connections	1 piece	00405

Wall Elbow

made from brass, with 1/2" internal thread, with 3/4" euro-cone receptor
(can be combined with gabootherm® pipes using coupling adapter)

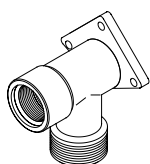

Code	Type	Unit	Item ID
GFL-WWKA	1/2" internal thread, 3/4" euro-cone	1 piece	02264

Insulation box with Rubber Pad

for wall elbows (GT-WWKA) in connection with valve support (GT-AT) for impact sound insulation. Impact sound insulation, incl. screws.

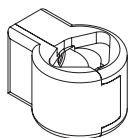

Code	Unit	Item ID
GT-DBW	1 piece	00473

Other Fittings:

Coupling Adapter

made from brass, with 3/4" euro-cone, consisting of main body with O-ring, clamping ring and cap nut (nickel-plated or not nickel-plated), for connecting gabootherm® pipes e.g. to the distributor station.

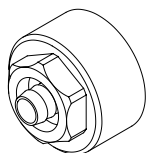

Code	Type	Unit	Item ID
GT-KA	12 x 1.3 nickel-plated	20 pieces	12655
	14 x 2.0 nickel-plated	20 pieces	07726
	15 x 1.5 not nickel-plated	20 pieces	12656
	16 x 2.0 not nickel-plated	20 pieces	07725
	17 x 2.0 not nickel-plated	20 pieces	07729
	18 x 2.0 not nickel-plated	20 pieces	07730
	20 x 2.0 not nickel-plated	20 pieces	07728
GFL-KA	16 x 2.2 not nickel-plated	10 pieces	05509
	20 x 2.8 not nickel-plated	10 pieces	05535

Coupling with External Thread

made from brass, with 1/2" external thread (SD = tested self-sealing).

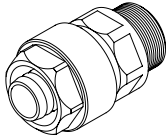

Code	Type	Unit	Item ID
GT-K	12 x 1.3 SD 1/2"	20 pieces	12733
	14 x 2.0 SD 1/2"	20 pieces	07440
	15 x 1.5 SD 1/2"	20 pieces	00404
	16 x 2.0 SD 1/2"	20 pieces	07444
	17 x 2.0 SD 1/2"	20 pieces	07616
GTF-K	18 x 2.0 SD 1/2"	20 pieces	03498
	20 x 2.0 SD 1/2"	20 pieces	09945
GFL-UK	16 x 2.2 1/2"	10 pieces	08310
	20 x 2.8 1/2"	10 pieces	08311
	20 x 2.8 3/4"	10 pieces	08312

Transition Reducer

made from brass, with 1/2" external thread, with 3/4" euro-cone receptor.

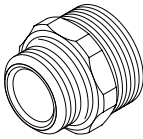

Code	Type	Unit	Item ID
GFL-UKAR	1/2"	10 pieces	01709

Elbow Coupling

made from brass, with 3/4" euro-cone receptor.

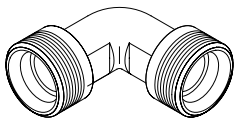

Code	Type	Unit	Item ID
GFL-WKA 16/20	3/4" euro-cone	1 piece	02204

Elbow Coupling, Reduced

made from brass, with 1/2" external thread, with 3/4" euro-cone receptor.

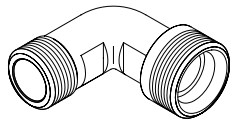

Code	Type	Unit	Item ID
GFL-WKAR	1/2" external thread, 3/4" euro-cone	1 piece	02265

T- Piece

made from gunmetal, with 3/4" euro-cone receptor.

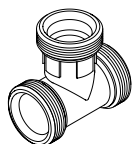

Code	Type	Unit	Item ID
GFL-TKA	3/4"	10 pieces	07911

Nipple with Euro-Cone

made from brass, tested by DVGW

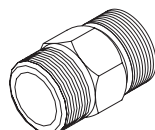

Code	Type	Unit	Item ID
GT-NEK	3/4"	10 pieces	00807

Reducing Piece

made from brass.

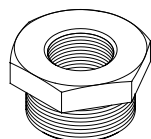

Code	Type	Unit	Item ID
GFL-RN	3/4" external thread - 1/2" internal thread	10 pieces	08193
	1" external thread - 3/4" internal thread	10 pieces	08194

For sanitary distributors and accessories, see chapter Distributors