

gabotherm®

Manifolds and Control Systems



Manifolds	Manifolds for Heating and Sanitary Installations	100
Distribution Boxes	Basic Boxes with Cover	103
Connectors	Fastening Material	103
Control Systems	Single Room Control	105

Manifolds and Accessories:

Each of the different gabotherm® heating and sanitary systems have a corresponding manifold.

For example, for the surface heating systems, a manifold station with flow meter and valve inserts for actuators is available; this manifold is also available as a plug version (heating pipes are connected using plug connectors, without tools) for the pipe dimension 15 x 1.5 mm.

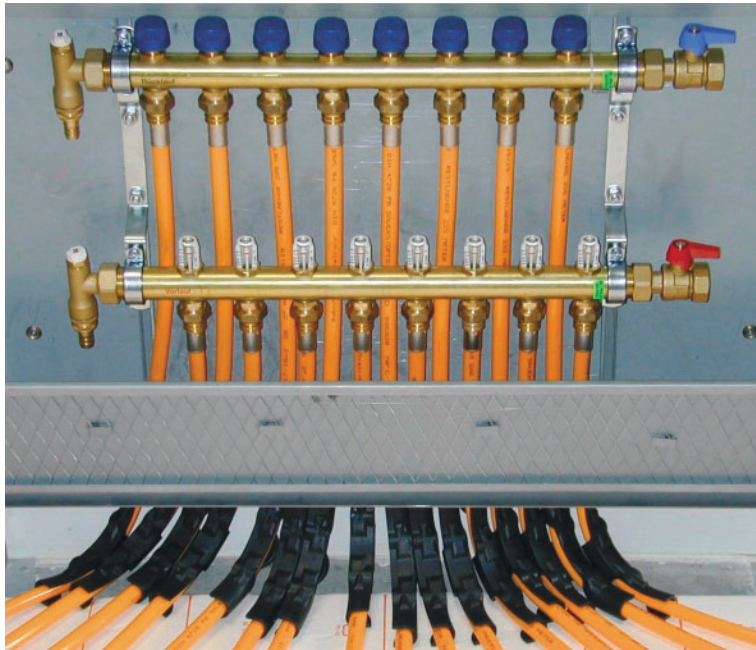

The manifold station for radiator connection contains $\frac{3}{4}$ " euro-cone outputs that can be connected by pressing or clamping using coupling adapters.

Available accessories for the heating manifolds are bleed valves, a heat quantity counter set or a fixed command control set.

The gabotherm® basic case can be combined with flush-mounted doors or an on-wall cover and is available in sizes suitable for all gabotherm® manifold stations.

Control Systems and Accessories:

There are 2 control system versions (electronic or radio control) available for the single room control of the gabotherm® surface heating systems – wall heating and floor heating.

The electronic single room control consists of the components room thermostat or room thermostat with clock and terminal strip for wiring the room thermostats to the servo-drives.

A pump module for connecting to the terminal strip is available for extending the control function, this module switches the heating pump off when the room thermostats indicate that no more warmth is required (wiring between terminal strip and heating pump required).

For the radio-controlled single room control, room thermostats, a radio terminal strip and servo-drive are also available.

A further control system version is regulation using a return flow temperature limiter. When a set temperature is reached, this device turns off the heating water supply by closing an integrated valve in the return flow pipe.

Single Room Control:

The room temperature is regulated using electronic room thermostats. The output signal of the room thermostat is transmitted by wire or by radio to the servo-drive via the terminal strip. The servo-drive (closed at zero current), which is located on the manifold bar, opens the valve that is integrated in the manifold when heat is required.

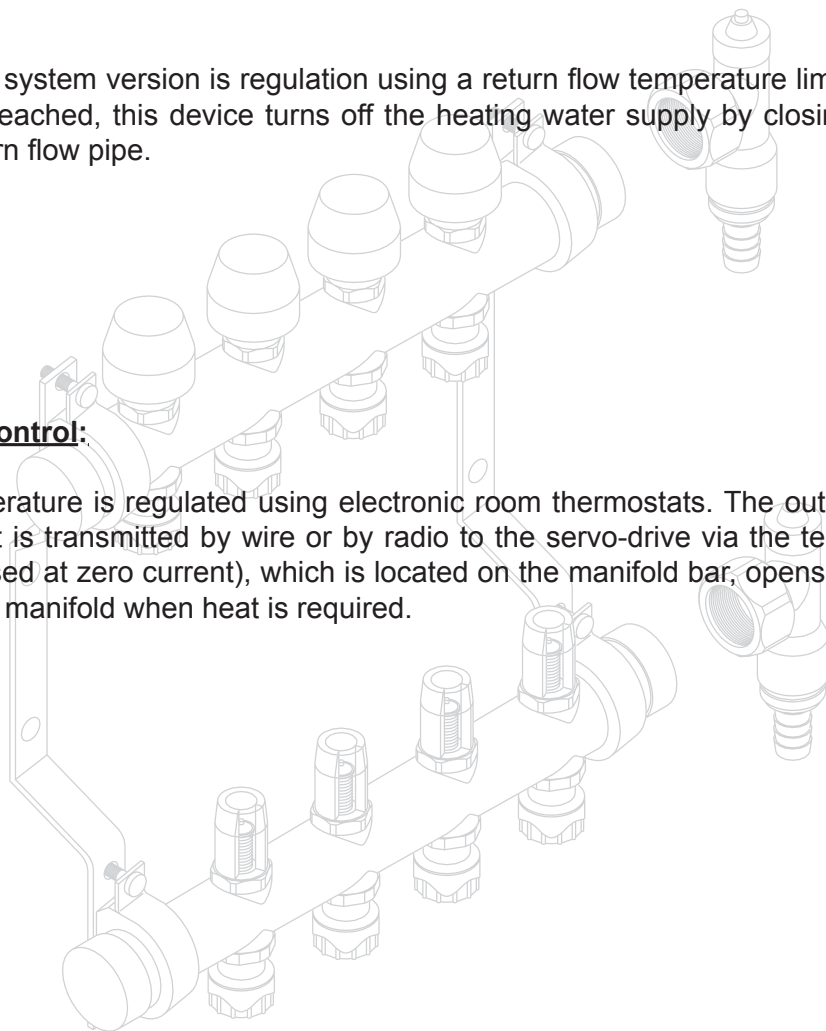

Manifolds for Surface Heating Systems

Manifold Station 1", for Surface Heating Systems

for inlet and return flow with valves, suitable for the connection of coupling adapters and press coupling adapters. Consisting of 2 corrosion-resistant manifold rails (brass), premounted on sound-insulated shackles, with 3/4" euro-cone outlets. Incl. deaeration and filling tap set. Adjustable flow regulation plus scale in the inlet flow, valve inlets for actuators in the return flow.

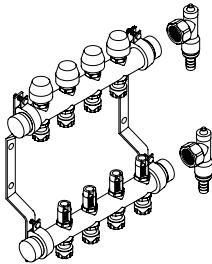

Code	Outlets	Width (mm)	Unit	Item ID
GTF-VSV 1"	2	190	1 piece	08351
	3	245	1 piece	08392
	4	300	1 piece	08459
	5	355	1 piece	08462
	6	410	1 piece	08479
	7	465	1 piece	08558
	8	520	1 piece	08563
	9	575	1 piece	08564
	10	630	1 piece	08572
	11	685	1 piece	08577
	12	740	1 piece	08589

Plug Manifold Station 1" with Integrated Plug Connections for gabotherm® PB Pipes 15 x 1.5 mm only

for inlet and return flow with valves, suitable for the connection of gabotherm® PB pipes 15 x 1.5 mm. Consisting of 2 corrosion-resistant manifold rails (brass), premounted on sound-insulated shackles, with integrated plug connectors d 15 mm. Incl. deaeration and filling tap set. Adjustable flow regulation plus scale in the inlet flow, valve inlets for actuators in the return flow.

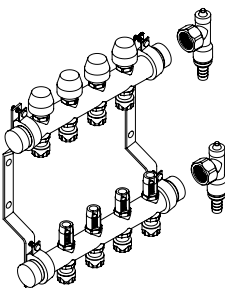

Code	Outlets	Width (mm)	Unit	Item ID
GTF-VSS 1"	2	190	1 piece	12737
	3	245	1 piece	12738
	4	300	1 piece	12739
	5	355	1 piece	12740
	6	410	1 piece	12741
	7	465	1 piece	12742
	8	520	1 piece	12743
	9	575	1 piece	12744
	10	630	1 piece	12745
	11	685	1 piece	12746
	12	740	1 piece	12747

Stainless Steel Pipe Collar

for calibrating the gabotherm® pipe 15 x 1.5 mm; absolutely necessary for plug manifolds.

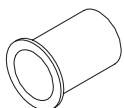

Code	Type	Unit	Item ID
GT-SH	15	10 piece	12717

Manifold for Radiator Connection

Manifold Station 1", for Radiator Connection

according to DIN 8076, suitable for press coupling adapter GT-PKA as well as coupling adapter GT-KA with 3/4" euro-cone outlets.

Ideal for use as an on-wall station or in the distribution box as an flush-mounted station.

Consisting of 2 manifold rails (brass), premounted on sound-insulated shackles.

Incl. deaeration and filling tap set.

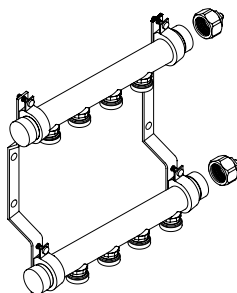

Code	Type	Width (mm)	Unit	Item ID
GT-VS 1"	2 A	190	1 piece	08198
	3 A	245	1 piece	08206
	4 A	300	1 piece	08207
	5 A	355	1 piece	08236
	6 A	410	1 piece	08238
	7 A	465	1 piece	08245
	8 A	520	1 piece	08272
	9 A	575	1 piece	08280
	10 A	630	1 piece	08283
	11 A	685	1 piece	08307
	12 A	740	1 piece	08324

The press coupling adapter and coupling adapter must be ordered separately for the corresponding pipe dimension.

Manifold Accessories

Bleed Valve 1"

for the main shutoff of the manifold station; **for heating installations only.**

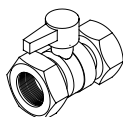

Code	Unit	Item ID
GT-AVR 1"	2 piece	01732

Heat Quantity Counter Set

suitable for 1" manifold, without heat quantity counter, suitable for counters with 110 and 130 mm total length, 1/2" connection for immersion sensor in the inlet flow, 1" connections from below. Valve in return flow with integrated factory setting.

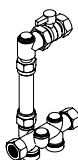

Code	Unit	Item ID
GTF- WMZ 1"	1 set	04840

Attention: requires larger distribution boxes!

Connection Elbow 1"

supplement for the heat quantity counter set for lateral connection of the supply pipe in the distribution box.

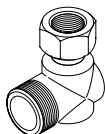

Code	Unit	Item ID
GTF- ASW 1"	1 piece	04385

Shut-Off Cock

for shutting off individual strands (e.g. floor tempering) with adapter receptor for euro-cone. **For heating installations only.**

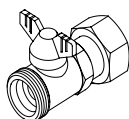

Code	Unit	Item ID
GT-AH 3/4"	1 piece	02201

Fixed Command Control Set

for regulating surface heating systems using the mixing principle, for installation on the floor heating manifold, consisting of thermostat valve with sensor (range 20–50°C), circulating pump (Grundfoss UPS 25-40), temperature limiter, connection elbow with deaeration valve, ½" filling tap, thermometer, regulating valves for inlet and return flow and flat seals. Pump and temperature limiter are already wired at the factory. The delivery height of the contained pumps must be verified by the heating system planner.

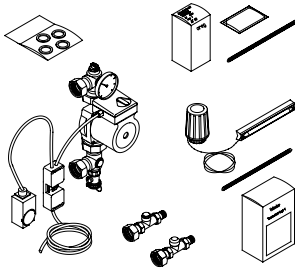

Code	Unit	Item ID
GTF-FWRS 1"	1 set	09937

Attention: requires larger distribution boxes!

Sanitary Manifolds and Accessories

Sanitary Manifold Element 1"

made from brass, with 1" internal thread connection on both sides, incl. 1" plug, with ½" outlets.

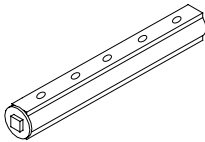

Code	Type	Width (mm)	Unit	Item ID
GFL-V	V2	115	1 piece	00064
	V4	225	1 piece	08778
	V6	335	1 piece	08779
	V8	445	1 piece	08780
	V10	555	1 piece	08781

Manifold Holder

made from chromated steel and sound-insulating insert, suitable for all manifold sizes GFL-V, for mounting on walls, in wall recesses or in the distribution box (2 holders for one manifold station).

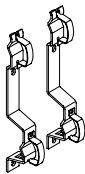

Code	Unit	Item ID
GFL-VH	1 set	08305

Blind Plug

made from brass, with ½" external thread, for closing free sanitary connections or for sealing manifold outlets on the sanitary manifold GFL-V.



Code	Unit	Item ID
GT-BS ½"	10 pieces	03527

Flat Seal ½"

free from asbestos, for sealing manifold outlets.



Code	Unit	Item ID
GFL-FD ½"	100 pieces	8502

Distribution Box (Modular)

Basic Case

made from Sendzimir-zinc-plated sheet steel, for flush-mounted or on-wall mounting of the distribution box, depth 110 mm, adjustable height (690-830 mm), with adjustable metal rails for fastening the manifold, with pipe deflection rail with plaster grille at the lower front side and cardboard plaster cover.

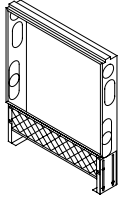

Code	Type	Width (mm)	Unit	Item ID
GT-VKMG	4	450	1 piece	12665
	7	680	1 piece	12666
	10	830	1 piece	12667
	12	1030	1 piece	12668
	12 plus	1140	1 piece	12669

Frame and Door (for Flush-Mounting)

made from Sendzimir-zinc-plated sheet steel, visible surfaces powder-coated white (approx. RAL 9010), for flush-mounting of the distribution box, frame depth is adjustable for ideal adjustment to the wall (approx. 60 mm) and rotatable, height 530 mm; door with steel lock for locking using square spanner.

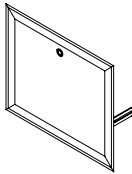

Code	Type	Width (mm)	Unit	Item ID
GT-VKMR	4	525	1 piece	12670
	7	755	1 piece	12671
	10	905	1 piece	12672
	12	1105	1 piece	12673
	12 plus	1205	1 piece	12674

On-wall Cover

made from Sendzimir-zinc-plated steel sheet, visible surfaces powder-coated white (approx. RAL 9010), for on-wall mounting of the distribution box, with plastic guiding elements on the interior side for ideal depth-adjustment to the wall.

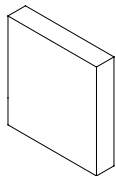

Code	Type	Width (mm)	Unit	Item ID
GT-VKMA	4	530	1 piece	12675
	7	760	1 piece	12676
	10	910	1 piece	12677
	12	1110	1 piece	12678
	12 plus	1210	1 piece	12679

Connecting Material, Miscellaneous

Single Pipe Clip

made from metal, for pipe in protective pipe



Code	d / protective pipe	Unit	Item ID
GT-S 21	21	100 pieces	05128
GFL-S 25	25	100 pieces	08341

Double Pipe Clip

made from metal, for pipe in protective pipe

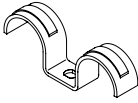

Code	d / protective pipe	Unit	Item ID
GT-DS 21	21	100 pieces	03360
GFL-DS 25	25	100 pieces	08343

Single Pipe Clip

made from metal, for 100% insulated pipe in protective pipe; for construction height up to 50 mm.

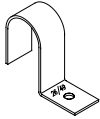

Code	d / protective pipe	Unit	Item ID
GT-S 50	21-25	50 piece	04831

Hammer-In Dowel

for fastening the pipe clips, length 35 mm



Code	Unit	Item ID
GT-SD 35	150 pieces	10412

Carrier Shell

made from zinc-plated steel sheet, in rods of 3 m, for gabootherm® PB pipes.

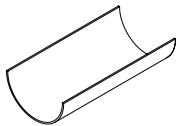

Code	Type	Unit	Item ID
GFL-Tragschale	15/16	10 x 3 m	09345
	18/20	10 x 3 m	09346
	25	10 x 3 m	02190
	32	10 x 3 m	02191

Pipe String

for fastening the carrier shell to the PB pipe.

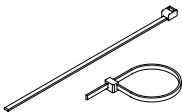

Code	Unit	Item ID
GFL-Rohrbinder 200 mm	100 pieces	02200

Floor Clamping Strip

made from plastic, 50 mm wide, 4 m long, for fixing the gabootherm® pipes or pipes in protective pipe d15, d20, d25 on the floor, pipe grid as indicated, predetermined separation point allows for easy extension of the strip.

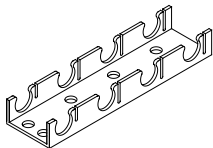

Code	pipe spacing	Height	Unit	Item ID
GTF-BKS 15	25	21 mm	2 m	12213
GTF-BKS 20	50	25 mm	4 m	12207
GTF-BKS 25	100	35 mm	4 m	12208

Holding Nails

for fastening the floor clamping strip.

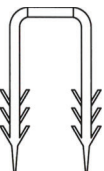

Code	Width	Height	Unit	Item ID
GTF-HN 50	20 mm	50 mm	250 pieces	02911
GTF-HN 40	20 mm	40 mm	50 pieces	12218

Control Systems

Analogue Single Room Control

Electronic Room Thermostat

230 V as a wall device for room temperature regulation in connection with terminal strip for controlling the actuators, temperature reduction possible, range restriction in the setting knob, protection type IP 30, protection class II. Dimensions: 75 x 75 x 27 mm; colour pure white RAL 9010;

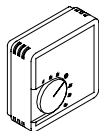

Code	Type	Unit	Item ID
GTF-ERT		1 piece	08347

Covering Frame for ERT

made from plastic, colour pure white (approx. RAL 9010), for mounting the room thermostats on standard flush-mounted boxes, e.g. for flush-mounted boxes that were not plastered cleanly.

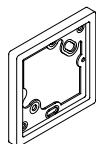

Code	Type	Unit	Item ID
GTF-ADR	(for ERT)	1 piece	12227

Electronic Room Clock Thermostat

230 V as a wall device with LCD display, in connection with terminal strip, 3 temperatures can be set, 6 times can be selected for each day, 1 extra day programme, self-learning heating curve, protection against access by unauthorised persons, pump/valve protection, antifreeze, dimensions: 71 x 142 x 32 mm; colour pure white RAL 9010;



Code	Type	Unit	Item ID
GTF-ERUT		1 piece	08335

Covering Frame for ERUT

made from plastic, colour pure white (approx. RAL 9010), for mounting the room clock thermostats on standard flush-mounted boxes, e.g. for flush-mounted boxes that were not plastered cleanly;

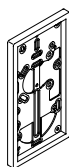

Code	Type	Unit	Item ID
GTF-ADRU	(for ERUT)	1 piece	12200

Terminal Strip

for easy wiring of the room temperature regulators ERT and ERUT, connection cable with earth contact type plug for 230 V, micro-fuse 6.3 mA with error control diode, for 8 or 6 room temperature regulators and 12 heating circuits.

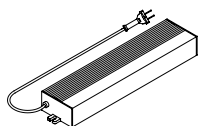

Code	Type	Unit	Item ID
GTF-KL	230/6	1 piece	08196
	230/8	1 piece	03396

Thermal Actuator

incl. valve adapter, closed at zero current, first open function, function display in cover, protection type IP 40, protection class II, connection line 2 x 0.5 mm (0.5 m long), 230 V / 24 V.

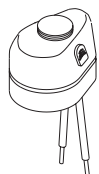

Code	Type	Unit	Item ID
GTF-TS 22z	230 V	1 piece	08188
	24 V	1 piece	08191

Pump Module

for switching the heating pump off when the room thermostats do not require any heat.
For connection to the terminal strip (GTF-KL 230); not suitable for radio-control!



Code	Type	for	Unit	Item ID
GTF-PM	230 / 6	KL-230 / 6	1 piece	03397

	230 / 8 *	KL-230 / 8 (plug insert) *	1 piece	09948
--	-----------	----------------------------	---------	-------

* without illustration

Radio-Controlled Single Room Control

Radio Room Thermostat

wireless, battery-powered, for room temperature regulation in connection with the radio terminal strip, simple operation using settings knob (5–30°C), switch with 4 functions (day temperature, night temperature, time control using master regulator, off setting), dimensions: 75 x 75 x 29 mm, colour pure white RAL 9010.

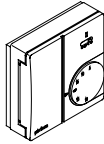

Code	Type	for	Unit	Item ID
GTF-FRT			1 piece	12007

Radio Clock Room Thermostat

wireless, battery-powered, as wall or handheld device, for room temperature regulation in connection with the radio terminal strip, clear LCD display for room temperature, time, day of week, operating type, time and temperature zone, dimensions: 71 x 142 x 22 mm, colour pure white RAL 9010.

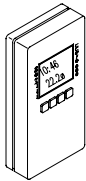

Code	Type	for	Unit	Item ID
GTF-FRUT			1 piece	08345

Radio Terminal Strip

radio receiver with integrated antenna, for transforming information from max. 4 or 6 radio clock room thermostats / radio room thermostats to control signals for max. 8 actuators, ready for connection to 230 V electric socket. With valve and radio test function, protection type IP 40, protection class II.

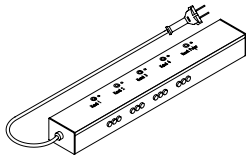

Code	Type	for	Unit	Item ID
GTF-FKL	4		1 piece	08325

	6		1 piece	08334
--	---	--	---------	-------

Thermal Actuator

incl. valve adapter, closed at zero current, first open function, function display in cover, protection type IP 40, protection class II, connection line 2 x 0.5 mm (0.5 m long), 230 V / 24 V.

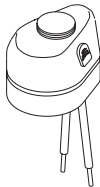

Code	Type	for	Unit	Item ID
GTF-TS 22z	230 V		1 piece	08188

	24 V		1 piece	08191
--	------	--	---------	-------

Return Flow Temperature Limiter

for wall installation incl. casing, set value range 20–40°C, valve connection ¼" euro-cone or ½" internal thread;

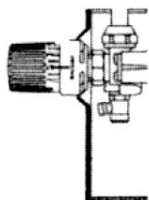

Code	Type	for	Unit	Item ID
GTH-RTB			1 piece	00134